

## 1M CHANNEL & 316 STAINLESS STEEL GRATE

Products covered in this spec sheet are as listed below:

Product	Code	Class	Weight	Flow	Slip Rating	Slot Width
1M (100mm)	81685/83916	B	5.27kg	1014 (L/min per meter)	P3	6mm
Corner (100mm)	81705/83946	B	1.75kg	1014 (L/min per meter)	P3	6mm
1M (150mm)	81605/83976	B	10.4kg	1605 (L/min per meter)	P3	6mm
1M (200mm)	81655/83986	B	15.4kg	2028 (L/min per meter)	P4	6mm

### Material

Marine-grade stainless steel 316, installed in a recycled polymer channel.

### Suitable Applications



HIGH RAINFALL

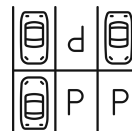

CARPARK

\*When installed in concrete



SWIMMING POOL

### Warranty

Polymer 5 Years

Steel Grate 3 Year

### Product Drawing

#### 100MM PROFILE

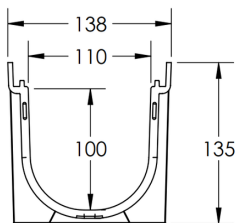

90 & 100MM PIPE CONNECTIONS

#### TOP

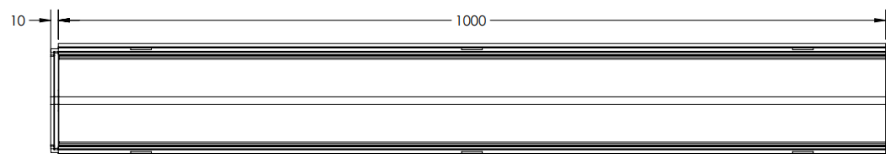

#### BOTTOM

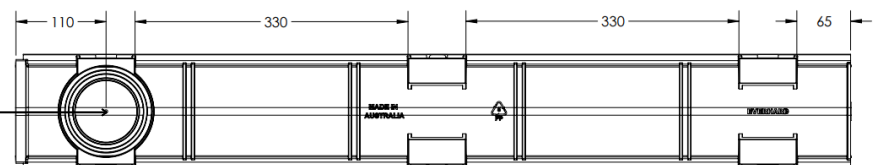

#### SIDE

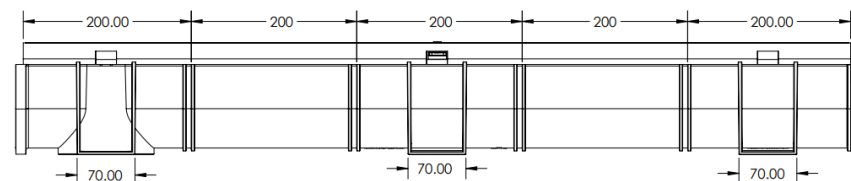

Disclaimer: All measurement are in millimetres and are solely for reference purposes. Colours have been reproduced with as much accuracy as possible. Any changes resulting from technical advance of design or colour may be made without prior notice. Further information on warranties is available at [www.everhard.com.au](http://www.everhard.com.au)

## Product Drawings Continued

150MM PROFILE

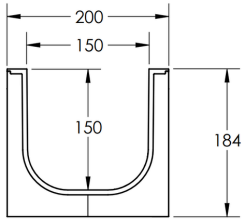

TOP

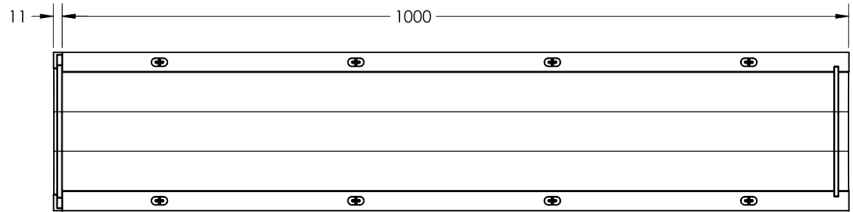

BOTTOM

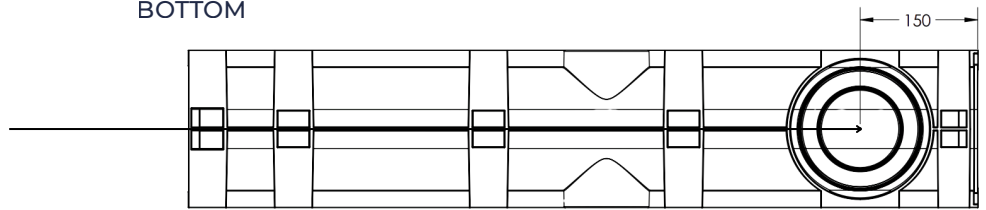

100 & 150MM PIPE CONNECTIONS

SIDE

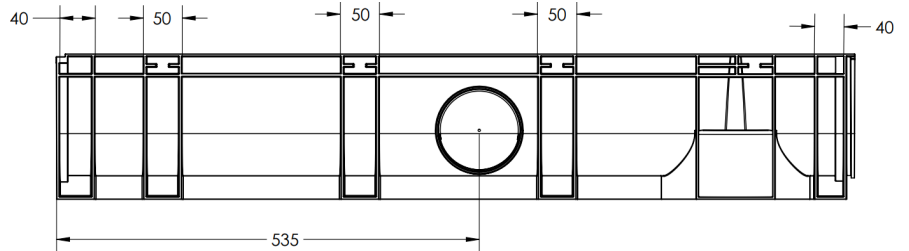

200MM PROFILE

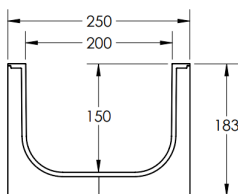

TOP

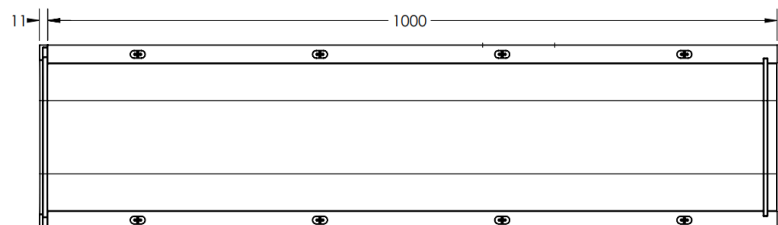

BOTTOM

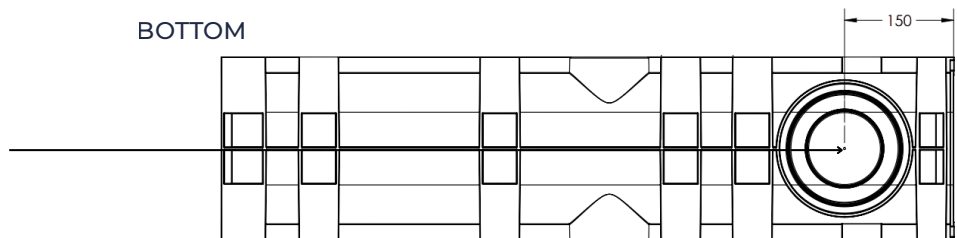

100 & 150MM PIPE CONNECTIONS

SIDE

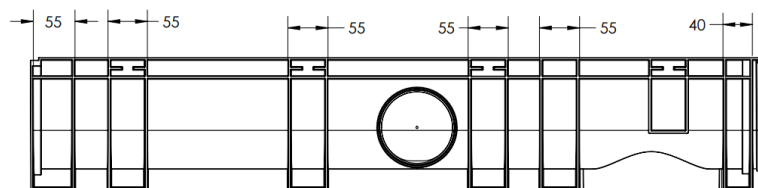

Disclaimer: All measurement are in millimetres and are solely for reference purposes. Colours have been reproduced with as much accuracy as possible. Any changes resulting from technical advance of design or colour may be made without prior notice. Further information on warranties is available at [www.everhard.com.au](http://www.everhard.com.au)