

1M CHANNEL & DUCTILE IRON GRATE

Products covered in this spec sheet are as listed below:

Product	Code	Class	Weight	Flow	Slip Rating	Slot Width
1M (150mm)	81604	D	20.6kg	1060 (L/min per meter)	P5	6mm
1M (200mm)	81654	D	26.9kg	1854 (L/min per meter)	P5	6mm

Material

Ductile cast iron in a recycled polymer channel.

Suitable Applications



HIGH RAINFALL

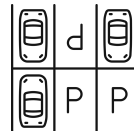

CARPARK

*When installed in concrete



OUTDOOR

Warranty

Polymer 5 Years

Ductile Iron Grate 1 Year

Product Drawing

150MM PROFILE

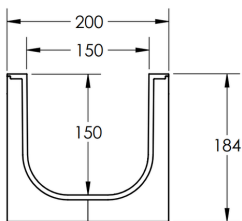

100 & 150MM PIPE CONNECTIONS

TOP

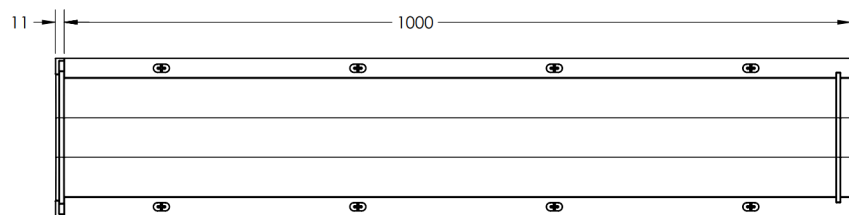

BOTTOM

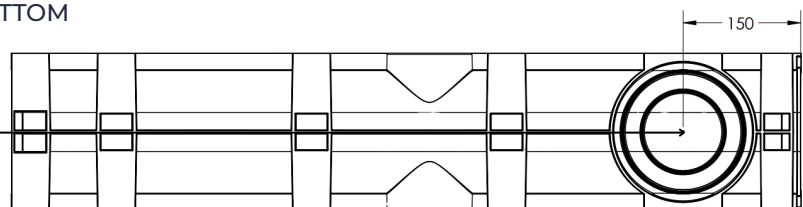

SIDE

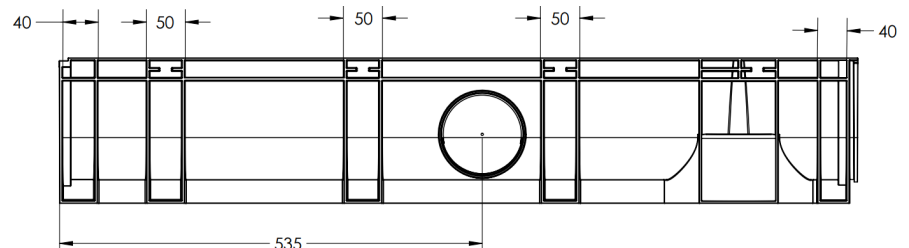

Disclaimer: All measurement are in millimetres and are solely for reference purposes. Colours have been reproduced with as much accuracy as possible. Any changes resulting from technical advance of design or colour may be made without prior notice. Further information on warranties is available at www.everhard.com.au

Product Drawings Continued

200MM PROFILE

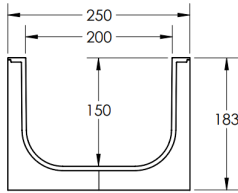

TOP

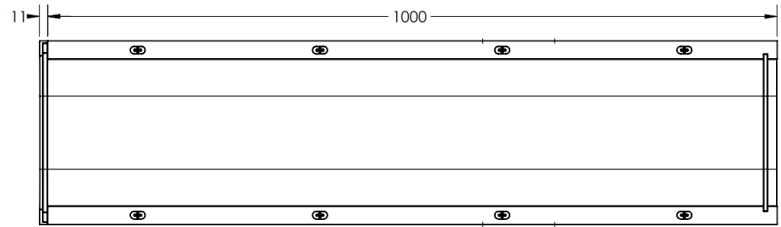

BOTTOM

100 & 150MM PIPE CONNECTIONS

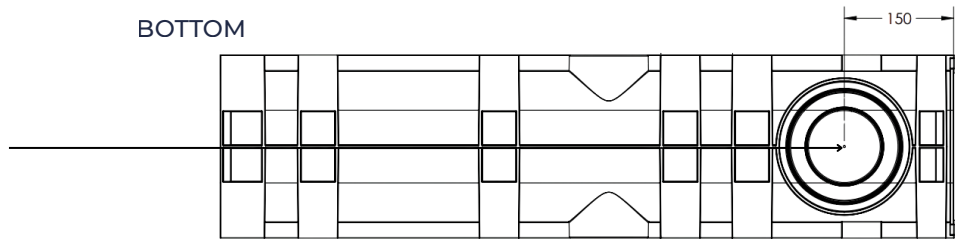

SIDE

